

# X SERIES PTZ CAMERA



Introducing our new X SERIES security camera, the XPTZ37XIP8MP-AI-N. With an impressive 8MP resolution and a versatile 5.5-202mm lens, this IP camera delivers crystal-clear footage with enhanced detail. With a powerful 37x optical zoom and 16x digital zoom, it ensures optimal coverage even over long distances. Equipped with IR technology extending up to 200m, integrated microphone and speaker, as well as audio/alarm in/out functionalities, it offers comprehensive monitoring solutions. Experience exceptional night vision in vivid color and robust durability with IK10 impact resistance and IP67 waterproof rating. Invest in peace of mind with the X SERIES security camera for uncompromising security surveillance.



## XPTZ37XIP8MP-AI-N



**8MP RESOLUTION**



**5.5-202MM LENS**



**IR UP TO 200M**



**37X OPTICAL ZOOM  
16X DIGITAL ZOOM**



**INTEGRATED  
MIC & SPEAKER**



**SEE IN COLOR AT NIGHT**



**AUTO-TRACKING**



**IMPACT RESISTANT**



**DETERRENCE LIGHTS**



**ALARM/AUDIO  
IN/OUT**



**WATERPROOF &  
DUST-TIGHT**



**MICRO SD CARD  
SLOT UP TO 256GB**



## CAMERA

IMAGING SENSOR	1/1.8" progressive scan CMOS
MAX. RESOLUTION	3840 × 2160
MIN. ILLUMINATION	Color: 0.0005Lux @ (F1.6, AGC ON), B/W: 0 lux with light
SHUTTER SPEED	1/5 s to 1/20000 s
SLOW SHUTTER	Yes
DAY & NIGHT	IR cut filter
ZOOM	37 × optical, 16 × digital

## LENS

FOCAL LENGTH	5.5 mm to 202 mm
FOV	Horizontal field of view: 60° to 2.31° (wide-tele) Vertical field of view: 35.5° to 1.3° (wide-tele) Diagonal field of view: 67.5° to 2.65° (wide-tele)
APERTURE	Max. F1.6
FOCUS	Auto, semi-auto, manual
SUPPLEMENT LIGHT RANGE	White light: up to 25 m, IR: up to 200m
SUPPLEMENT LIGHT TYPE	Hybrid (IR and White Light)

## PTZ

MOVEMENT RANGE(PAN)	360°
MOVEMENT RANGE(TILT)	-20° to 90° (auto flip)
PAN SPEED	Configurable from 0.6° to 200°/s; preset speed: 200°/s
TILT SPEED	Configurable from 0.6° to 90°/s, preset speed 100°/s
PROPORTIONAL PAN	Yes
PRESETS	255
PATROL SCAN	4 patrols, up to 32 presets for each patrol
PATTERN SCAN	4 pattern scans
POWER-OFF MEMORY	Yes
PARK ACTION	Preset, pattern scan, auto scan, patrol scan
3D POSITIONING	Yes
PTZ STATUS DISPLAY	Yes
SCHEDULED TASK	Preset, pattern scan, patrol scan, auto scan

## VIDEO

MAIN STREAM	50 Hz: 25 fps (3840 × 2160, 3072 × 1728, 2592 × 1944, 2592 × 1520, 2304 × 1296, 1920 × 1080, 1280 × 960, 1280 × 720); 60 Hz: 30 fps (3840 × 2160, 3072 × 1728, 2592 × 1944, 2592 × 1520, 2304 × 1296, 1920 × 1080, 1280 × 960, 1280 × 720);
SUB-STREAM	50 Hz: 25 fps (1920 × 1080, 1280 × 720, 640 × 480, 320 × 240); 60 Hz: 30 fps (1920 × 1080, 1280 × 720, 640 × 480, 320 × 240);
THIRD STREAM	50 Hz: 25 fps ( 640 × 480, 320 × 240); 60 Hz: 30 fps ( 640 × 480, 320 × 240);
VIDEO COMPRESSION	Main stream: H.265+/H.265/H.264+/H.264 Sub-stream: H.265+/H.265/H.264+/H.264/MJPEG Third stream: H.265+/H.265/H.264+/H.264
VIDEO BIT RATE	16 kbps to 16384 kbps
H.264 TYPE	Baseline Profile/Main Profile/High Profile
H.265 TYPE	Main Profile
REGION OF INTEREST (ROI)	8 fixed regions for each stream
AUDIO COMPRESSION	G.711alaw, G.711ulaw
AUDIO BIT RATE	64 Kbps (G.711)
AUDIO SAMPLING RATE	8 kHz
ENVIRONMENT NOISE FILTERING	Yes

## NETWORK

NETWORK STORAGE	NAS (NFS, SMB/CIFS), auto network replenishment (ANR)
PROTOCOLS	IPv4/IPv6, HTTP, HTTPS, FTP, SMTP, UPnP, SNMP, DNS, DDNS, NTP, RTSP, RTP, TCP/IP, UDP, DHCP, PPPoE, RTMP
API	Onvif ( Profile S, Profile G, Profile T),Http API
SIMULTANEOUS LIVE VIEW	Up to 20 channels
USER/HOST	Up to 32 users, 3 user levels: administrator, operator, and user
SECURITY	Password protection, complicated password, HTTPS encryption, IP address filter,control timeout settings
CLIENT	VMS
WEB	IE10/11, Safari V12.1 above, Firefox V.52 above, Google chrome V.57 above, Edge V.79 above

## IMAGE

DAY/NIGHT SWITCH	Day, Night, Auto, Schedule
IMAGE ENHANCEMENT	BLC, HLC, 3D DNR
WIDE DYNAMIC RANGE (WDR)	120 dB
DEFOG	Digital defog
IMAGE STABILIZATION	DIS
IMAGE SETTINGS	Saturation, brightness, contrast, sharpness, gain, and white balance adjustable by client software or web browser
PRIVACY MASK	8 privacy masks
SNR	> 52 dB

## INTERFACE

ETHERNET INTERFACE	1 RJ45 10M/100M self-adaptive Ethernet port
ON-BOARD STORAGE	Built-in SD card slot, support microSD/SDHC/SDXC card, up to 256 GB
ALARM	1 inputs, 1 output
AUDIO	1 input (line in); 1 output (line out)
RESET	Yes
BUILT-IN MICROPHONE	1 built-in microphone
BUILT-IN SPEAKER	1 built-in speaker

## GENERAL

POWER	36VDC / IEEE802.3bt(PoE++)
OPERATING CONDITION	-40 °C to 65 °C (-22 °F to 149 °F) Humidity 90% or less (non-condensing)
DEMIST	Yes
MATERIAL	Metal
DIMENSIONS	Ø 206.4 mm × 337.3 mm (Ø8.13" × 13.27")
WEIGHT	Approx. 6.335kg (Wall mount bracket: 1035g)
PROTECTION	IP67, IK10

## EVENT

BASIC EVENT	Motion detection, video tampering alarm, alarm input and output
DEEP LEARNING FUNCTION	Face Recognition, Human & Vehicle Detection, Perimeter Intrusion Detection, Line Crossing Detection, Stationary Object Detection, Crossing Counting, Heat Map, Crowd Density Detection, Queue Length Detection, License Plate Detection
SMART TRACKING	auto-tracking
ALARM LINKAGE	Upload to FTP, send email, trigger alarm output, trigger recording



2024 Global Surveillance Development, GSD Group and GSD are registered trademarks of Global Surveillance Development Group, Inc. in Canada and / or other countries. We reserve the right to change the design and specifications of the product Without notice and without incurring any obligation.

## DIMENSIONS

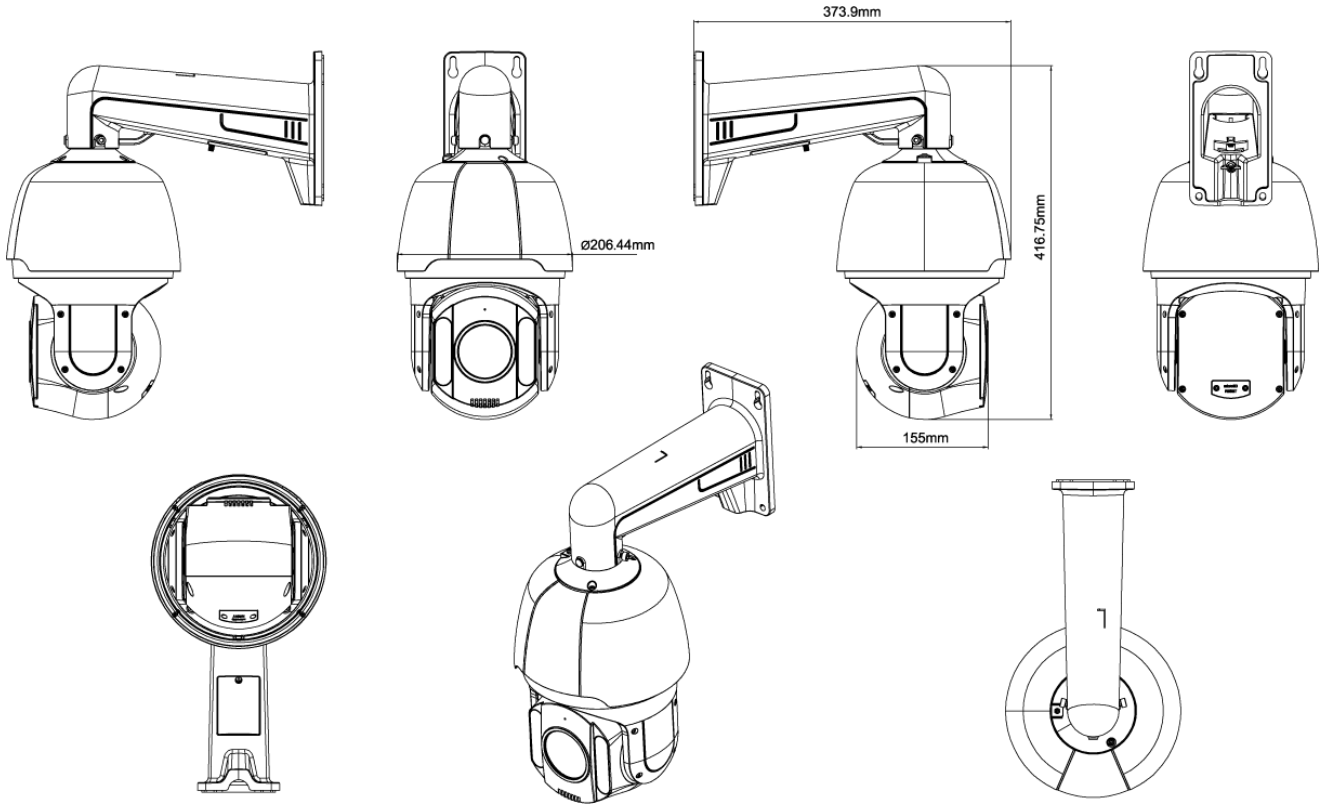

## ACCESSORIES



**WMB8**  
WALLMOUNT BRACKET



**CMB6-P**  
CEILING MOUNT BRACKET



**DBASEX-C**  
PENDANT FOR DBASEX



**DBASEX-P**  
PENDANT FOR DBASEX